

Stenhøj Mono

Stenhøj Mono

Centre-ram underground lifts

The STENHØJ Mono program is a comprehensive and flexible program; comprising lifts with superstructures, arms or platforms. All Mono lifts are available in either semi-hydraulic or high pressure versions. They are especially suitable for service, body work, brakes /wheels, paint shops, lubrication, washing and under body sealing.

All Mono lifts have capacities of 3 t; with the exception of Mono Flex H 50, which has 5 t capacity, and Mono Flex H 20, which has 2 t capacity.

Mono Flex H 30 is delivered with flat H-support, and can also be used as lifting unit for chassis alignment benches.

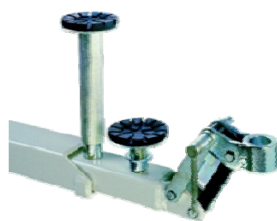

Mono Flex H 30 is available with either combiflex

or screw pads.

We offer an extensive program of extra pads for the combiflex versions.



STENHØJ
lifting the level

Stenhøj Mono

Stenhøj Mono Quick & Drive-On

Centre-ram underground lifts

STENHØJ Mono Drive-on 30 has a lifting capacity of 3 t and is delivered as standard with flush platforms and fixed front stops.

Drive-on ramps automatically form rear stops, when lift is raised. A set of aluminium guiding edges are inclusive in the lift delivery.

STENHØJ Mono Quick 30 has a lifting capacity of 3 t. A set of four 80 mm rubber blocks is inclusive in the lift delivery.

Mono Quick has a very low minimum height – only 57 mm; and an extension length of 1400-2000 mm.

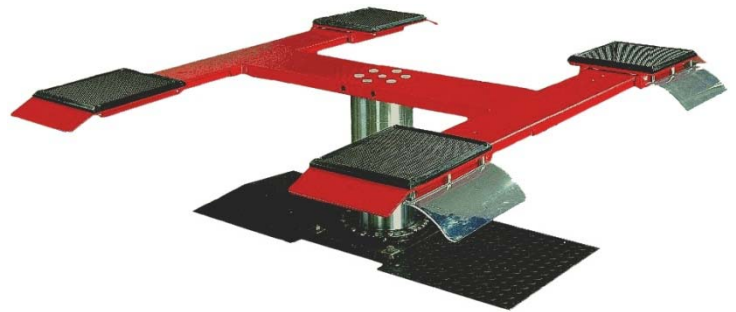
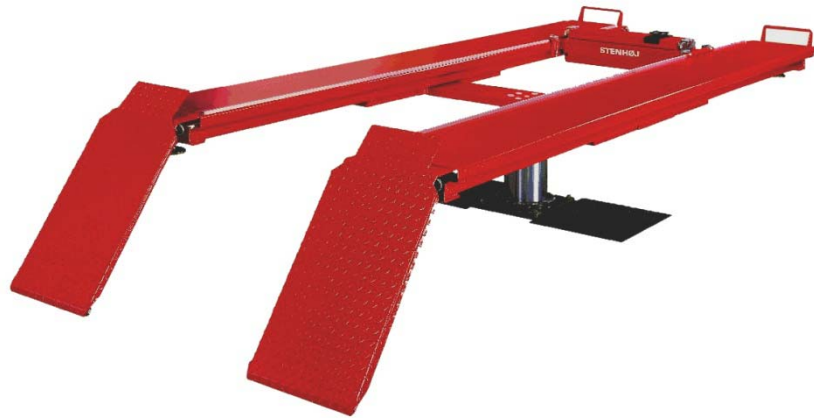

Micro 20 – 2 t scissor jack available as optional extra for the Mono Drive-on 30.

Bent profile platforms which prevent deflection.

Adjustable XY-pads available as optional extra for the Mono Quick 30.



STENHØJ
lifting the level

Stenhøj Mono

Stenhøj Mono

Centre-ram underground lifts

The hydraulic principle:

Semi-hydraulic lift:

Opening of the control valve allows compressed air to flow into the cylinder piston, and the lift rises. Necessary air pressure: 10 bar.

High pressure lift:

Pushing the UP-button allows the oil to flow into a high pressure cylinder in the lift piston, and the lift rises. Only a small quantity of oil is required, and the lift is not dependant on the supply of compressed air in the workshop.

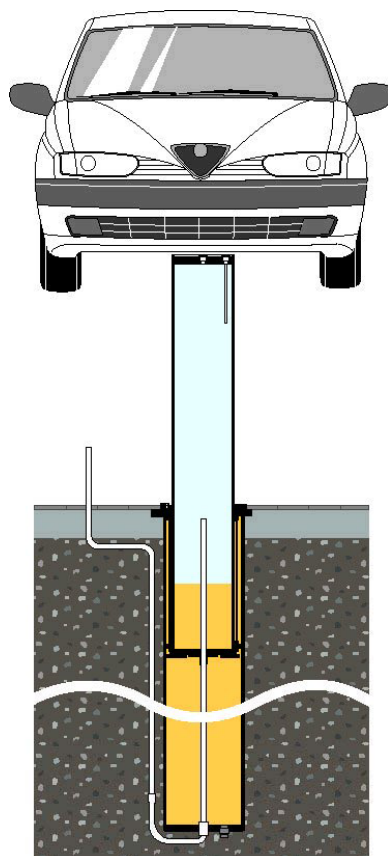

Semi-hydraulic lift

Operated by means of compressors.

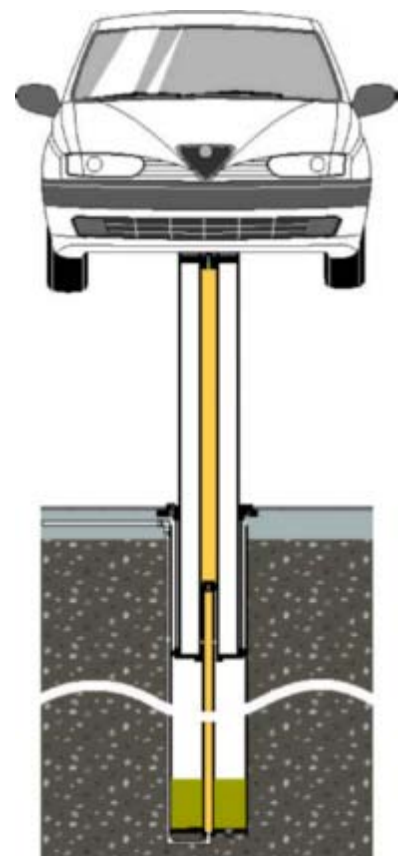

High pressure lift

Delivered with single pump- or central pump unit.



STENHØJ
lifting the level

Oil requirements:

3 ton: 140 litres on the cylinder

5 ton: 225 litres on the cylinder

Oil requirements:

3 ton: 40 litres on the cylinder
10 litres on the pump unit

5 ton: 30 litres on the cylinder
15 litres on the pump unit

CORROSION-PROOF SURFACE TREATMENT

All Stenhøj lifts are led through a sling purifying plant (according to SA2.50 – ISO-Norm 8501-1:2007), dipped in primer, and finally led through an electro-static powder bake plant.

Technical data

	Mono 30	Mono 50
Lifting capacity	3000 kg	5000 kg
Lifting/lowering time (high pressure)	35 sec.	64 sec.
Stroke length	1750 mm	1750 mm
Piston diameter	238 mm	340 mm (semi-hydraulic) 238 mm (high pressure)

Mono Flex H 30	A	B	C	D	E	F	G	H	I	J
w/screw pads	420	120	Ø120	Min. 645 / Max. 1040	1410	2015	950	1455	1410	2200
w/combiflex pads	420	120	Ø120	Min. 655 / Max. 940	1425	1860	965	1330	1430	2000
w/combiflex pads	420	120	Ø120	Min. 720 / Max.1070	1525	2060	1045	1495	1560	2260
w/combiflex pads	310	590	Ø120	Min. 720 / Max.1070	1410	1950	1515	1965	2030	2730
w/combiflex pads	420	120	Ø120	Min. 910 / Max. 1400	1815	2565	1290	1920	1940	2920
w/combiflex pads	280	510	Ø120	Min. 830 / Max. 1395	1495	2350	1600	2210	2710	3300

Mono Quick

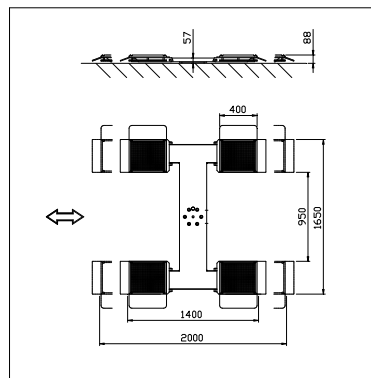

Mono Drive-on

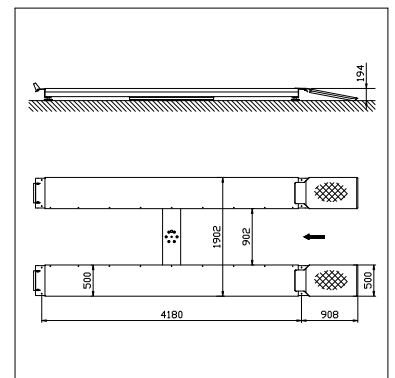

Mono Flex H 30

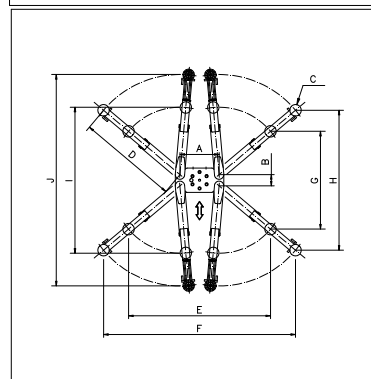

Mono Flex H 50

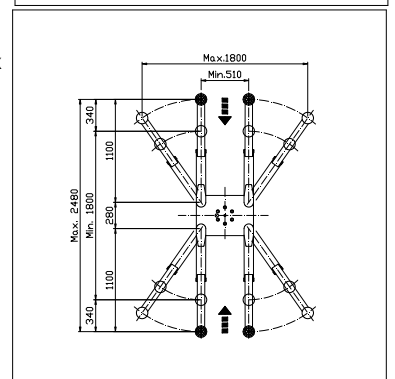

Pad types for H30

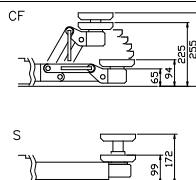

Flip-up pad for H50

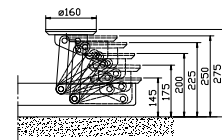

Standard colours

Red RAL 3013
White RAL 9002

No liability accepted for specifications, which are subject to alteration.